



Catalog Number: WMG-PC19
Product ID: 7TAD105290R0006
UPC Number: 78621077016
EAN Number: 05415022258592
Status: A



Actual

Stainless Steel Wire Mesh Grip for Use with 1-1/2 Inch Cord Fittings, UL, CSA, Grip Range 1.375 to 1.500 Inch

- Prevents severe cord bends and pullouts.
- Used with aluminum and/or steel fittings.
- Provides high gripping strength for adequate cable support and strain relief without damage to the cable sheath.

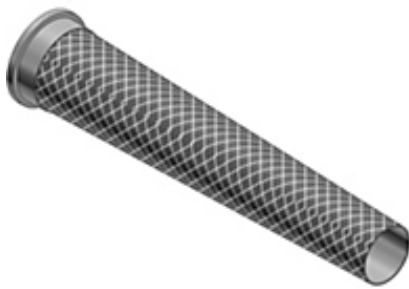

Representative

North American Specifications (UNSPSC)

UNSPSC	39121431 Cable gland connector
IGCC	4601 Cable gland connector
Type	Wiremesh Grips
Special Features	Prevents Severe Cord Bends and Pullouts
Application	Provides High Gripping Strength for Adequate Cable Support and Strain Relief Without Damage to the Cable Sheath
Standard	UL E13938, CSA
Conductor Range	1.375 to 1.500 Inch
Material	Stainless Steel
Environmental Conditions	Ordinary Locations

Packaging

Inner Quantity	2
Inner Dimensions (inches)	6x4.5x3
Outer Quantity	10
Outer Dimensions (inches)	24.2x6.2x3.5
Weight Uom	35 lbs. per 100

Documents / Support Tools

Technical Drawing / Data Sheet	TDS000055
Instruction Sheet	TA00083-TB2
Support/Tools	Available on Website

Header

3D Model	Available on Website
----------	----------------------